

Underfloor Heating Installation Guide

Floor Constructions: Screed Floor

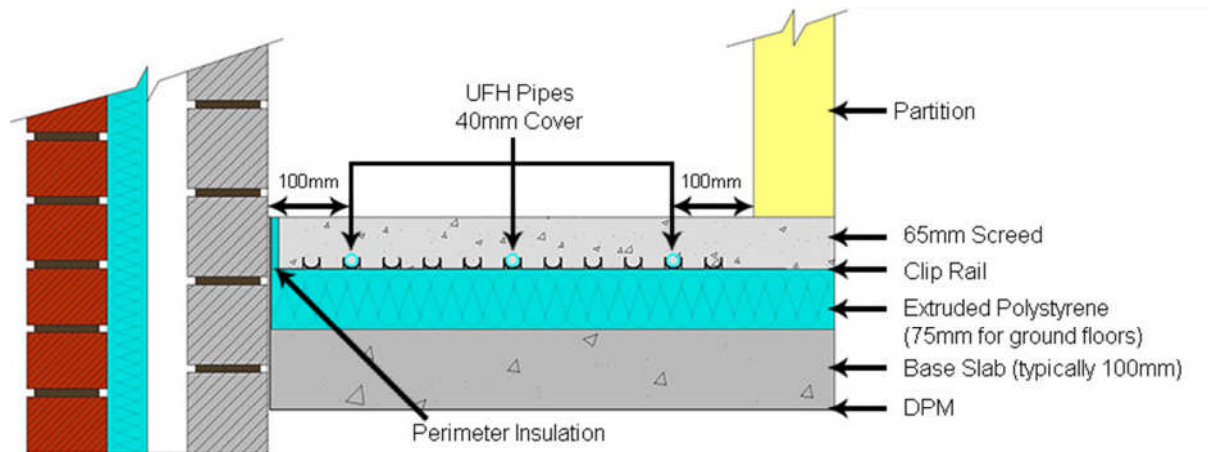

Insulation

In this system, insulation is installed onto the subfloor / ground bearing floor slab / block and beam or suspended concrete floor to stop the downward transfer of heat and supply maximum efficiency. Ideally the insulation should be of a foil backed variety such as Kingspan or Celotex. Grade and thickness of insulation should be specified by the architect to comply with building regulations. Perimeter edge insulation should be installed to prevent thermal bridging between the screed floor and the wall.

Fixings

Either barbed pipe clips or cliprail are used to fix the pipe to the insulation boards. At the ends of loops, and at any other points where the pipe is 'sitting up' from the insulation, additional staples should be used to secure the pipe before screeding.

In certain circumstances (where little or no insulation is installed) A98 or A142 reinforcing steel mesh can be laid on the floor, the pipe can then be fixed to the mesh using cable ties.

Screed

The screed must comply with British Standard Codes of Practice and be allowed to dry out slowly and naturally.